

Grossmont College Evacuation Plan

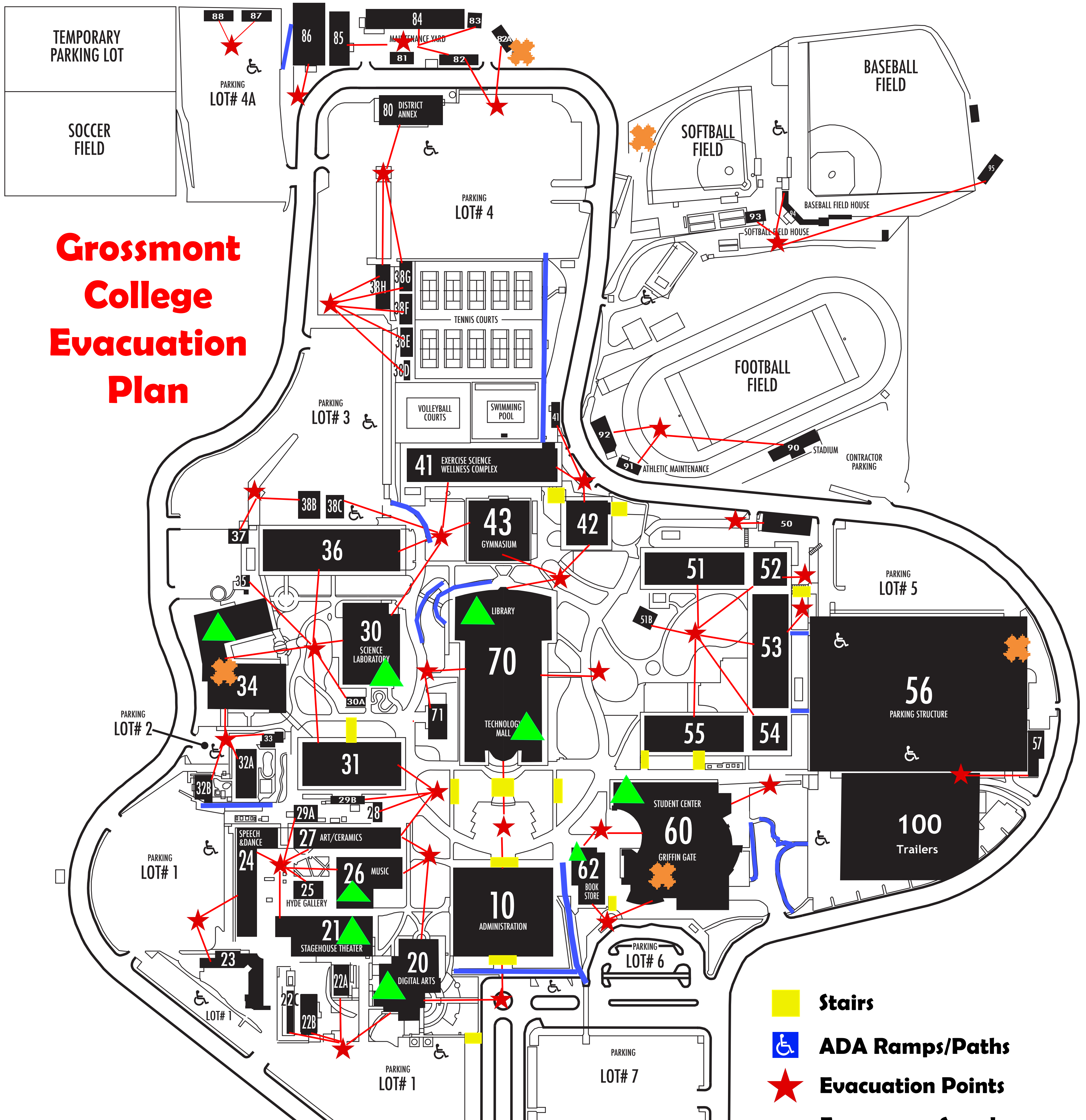

- Stairs
- ♿ ADA Ramps/Paths
- ★ Evacuation Points
- ★ Emergency Supply Cache Locations
- ▲ Evacu-Trac Locations

Evacuation Tips:

- Always move at least 150 feet away from the affected location.
- If smoke or flames are present dial 911.
- Follow your building marshals instructions. -Do not re-enter the building unless told to do so by authorized authorities.
- Do not use the elevators.
- Seek and assist disabled persons.

Grossmont College	In Place	Location of <u>Evacu-Trac</u>
Building 20 Digital Arts	Y	Second Floor NW next to stairwell
Building 21 Stage House Theater	Y	Second floor next to elevator
Building 26 Music Building	Y	Second floor next to stairwell
Building 30 Science Laboratory	Y	Second floor NW next to elevator
Building 34 Health and Sciences	Y	Second floor lobby
Building 60 Student Center	Y	Second floor by elevator
Building 62 Bookstore	Y	Second floor next to elevator
Building 70 Library	Y	Second floor NE section
Building 70 Technology Mall	Y	Second floor SE section (2)